

## Grade 80 - End Fittings

### GPT-MLA-002 - Master link assembly

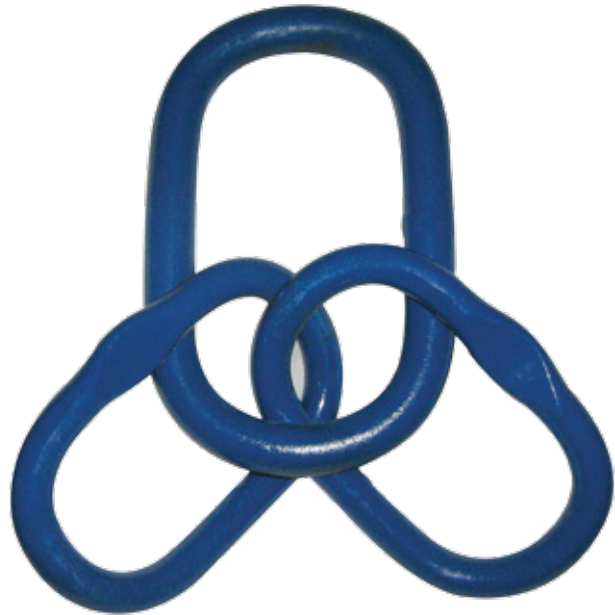
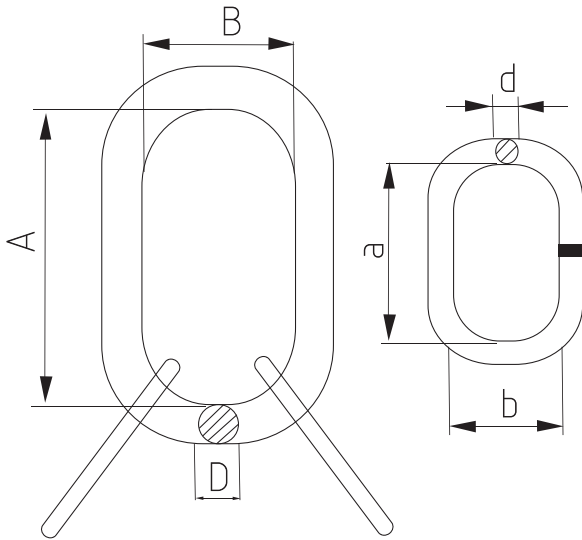

#### Description:

- Designed for use with steel wire rope or grade 80 alloy steel chain
- For overhead lifting application
- Size, CE, WLL, Traceability code & GRIPTON or GPT embossed

Standard: BS EN 1677-4

Material: Alloy steel

Factor of safety: 4 to 1

Construction: Quenched & tempered

Proof load: 2 times of working load limit

Finish: Powder coated

Master Link Assembly

Item No.	WLL (T)	A (mm)	B (mm)	D (mm)	a (mm)	b (mm)	d (mm)	Weight (Kg)
Q20B	5.8	170	90	20	120	70	16	2.41
Q22B	7.6	170	90	22	150	80	20	3.77
Q25B	10	190	100	25	150	80	20	4.45
Q28B	12.7	210	110	28	170	90	22	6.12
Q32B	15.2	270	140	32	190	100	25	9.47
Q38B	25	270	140	38	270	140	32	17.4
Q45B	34	320	170	45	270	140	38	26.76
Q50B	40	380	200	50	270	140	38	33.2
Q60B	58	430	220	60	380	200	50	66
Q70B	84	500	250	70	430	220	60	103