

Material Handling Equipment

GPT-PHT-016 - Push trolley

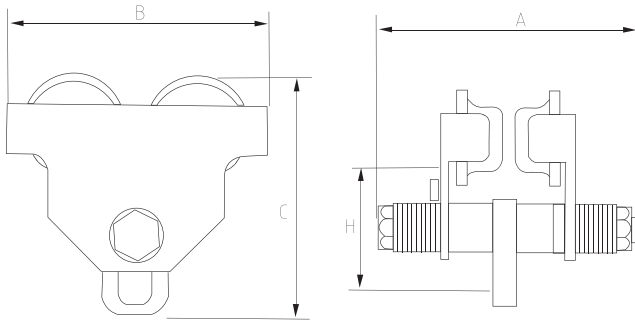

Description:

- Suitable for flat and minor irregular surfaces
- Easy installation
- Suspension eye allows easy connection to hooks and other lifting gears
- CE, Traceability code, WLL & GRIPTON mentioned on label

GPT-GHT-017 - Geared trolley

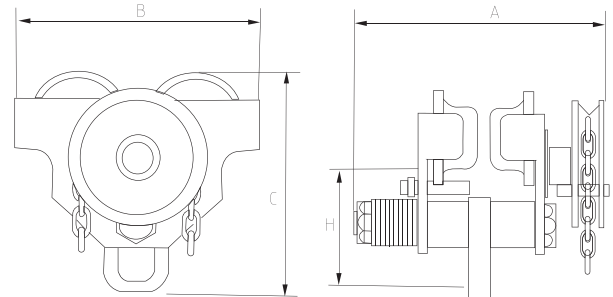

- Standard: EN 13195
 Material: Carbon steel
 Factor of safety: 4 to 1
 Construction: Quenched & tempered
 Proof load: Individually proof tested to 1.5 time of working load limit
 Finish: Powder coated

GPT-PHT-016 - Push trolley

Push trolley						
WLL (T)	I beam recommended A (mm)	A (mm)	B (mm)	C (mm)	H (mm)	Net weight (Kg)
0.5	68 - 126	208	196	190	108	5.5
1	80 - 146	242	236	211	115	9.5
2	80 - 168	280	273	236	130	13.5
3	88 - 168	300	320	295	164	25
5	100 - 170	316	366	334	177	36
10	122 - 203	343	389	460	237	68



GPT-GHT-017 - Geared trolley

Geared trolley						
WLL (T)	I beam recommended A (mm)	A (mm)	B (mm)	C (mm)	H (mm)	Net weight (Kg)
0.5	68 - 126	248	196	190	108	9
1	80 - 146	280	236	211	115	13
2	80 - 168	318	273	236	130	18
3	88 - 168	340	320	295	164	25
5	100 - 170	365	366	334	177	39
10	122 - 203	410	389	460	237	70

